



# 11th Annual Critical Care Conference in the Vineyards

Thursday 5th and Friday 6th May 2016

Crowne Plaza Hunter Valley  
Lovedale, Hunter Valley

## **PROGRAM AND REGISTRATION**

Closing Date: Monday 18 April 2016

*INNOVATIVE | INSIGHTFUL | INSPIRING*



**Health**

Hunter New England  
Local Health Network

Registration and Program Brochures are also available at the following websites:  
<http://mylink.hnehealth.nsw.gov.au/course/view.php?id=860>



## About the Conference

This Critical Care Conference has been organised by Hunter New England Health professionals to support networking, sharing of innovation and learnings experienced locally, and from a NSW or interstate perspective. The conference has been held annually for the past 11 years in the Hunter Valley.

Trade Displays will be open during program breaks and we encourage all delegates to support these conference sponsors.

### Conference Committee

Conference committee members represent different specialities in the area of Critical Care from the Hunter New England Local Health District (HNE LHD).

Louise Abel – Executive Assistant Trauma Services – HNE LHD

Robyn Aylward – CNC Rural Critical Care – HNE LHD

Karen Chronister (Chair) – CNC Critical Care ICU/HDU – HNE LHD

Nicole Coleman (Co Chair) – CNC Organ and Tissue Donation – HNE LHD

Nicole Lacey – CNC ED, John Hunter Hospital

Debra McDougall – Area CNC Trauma – HNE LHD

Kelvin Smith – CNC ICU, John Hunter Hospital

### Conference Enquiries

Karen Chronister

Office: (02) 4921 4783

Mobile: 0438 476 907

Fax: (02) 4921 4799

or Nicole Coleman Ph: (02) 4921 4464

Mobile: 0408 274 313

Conference Email:

[HNELHD-CriticalCare@hnehealth.nsw.gov.au](mailto:HNELHD-CriticalCare@hnehealth.nsw.gov.au)

## Thanks to our Sponsors

**GOLD SPONSOR**

**ZOLL®**

**SILVER SPONSOR**

**Teleflex**

**iMDsoft®**

# Program Wednesday 4th May 2016

1600-1800 - Pre conference registration in the Hotel Lobby

Thursday 5th May 2016 Held in the Conference and Events Centre (No. 3 on Hotel Map)

| TIME                           | TOPIC  | SPEAKER   |
|--------------------------------|--|---|
| <b>0730-0830</b>               | <b>Registration</b>  |   |
| <b>SESSION 1</b>               |  |   |
| <b>0845</b>                    | <b>Welcome to country</b>  | <i>To be advised</i>  |
| 0855                           | Housekeeping   | Karen Chronister - Rural CNC ICU & ICU Stream Coordinator, HNE LHD  |
| 0905                           | Opening Address  | Elizabeth Grist, Executive Director - Clinical Services, Nursing and Midwifery, HNELHD  |
| 0925                           | Embedding research in healthcare - a pathway to clinical excellence  | Conjoint Professor Christopher Levi, Director of Clinical Research and Translation, Research Innovation and Partnerships HNELHD & Senior Staff Neurologist John Hunter Hospital |
| <b>0945</b>                    | <b>Questions</b>   |   |
| 0950                           | Meditation, mindfulness and health   | Lawrence Keating, CNS ICU, St George Hospital   |
| <b>1010</b>                    | <b>Questions</b>   |   |
| 1015                           | Finger on the pulse: Tapping into social media for health education and collaboration  | Dr John Lambert, Chief Clinical Information Officer, eHealth  |
| <b>1035</b>                    | <b>Questions</b>   |   |
| <b>1040</b>                    | <b>Morning Tea / Trade Display</b>   |   |
| <b>SESSION 2 – Free papers</b> |  |   |
| 1110                           | I want everything but blood  | Simone Meakes, CNC, John Hunter Hospital Trauma Service   |
| 1130                           | Persistence pays off: Innovative methods to facilitate successful tracheostomy weaning and swallow rehabilitation  | Laura O'Carrigan, Senior Speech Pathologist, Concord Repatriation General Hospital  |
| 1140                           | Haven't I seen you before? Complex Care coordination in the John Hunter Emergency Department   | Kath Ferry, Chronic & Complex Care Coordinator  |
| 1200                           | Thyroid storm: case study  | Mark McLennan, CNC ICU Lismore and Grafton Hospitals  |
| 1220                           | Anticoagulation for CRRT, changing the standard  | Rhian Nathan-Marsh, CNE ICU, John Hunter Hospital   |
| <b>1230</b>                    | <b>Questions</b>   |   |
| <b>1240</b>                    | <b>Lunch / Trade Display</b>   |   |
| <b>SESSION 3</b>               |  |   |
| 1340                           | The magic of the ultrasound beam   | Jorge Brieva, Staff Specialist ICU JHH & Hospital Medical Specialist Organ and Tissue Donation  |
| <b>1400</b>                    | <b>Questions</b>   |   |
| 1405                           | "Once bitten"  | Kate King, CNC John Hunter Trauma Services and Cristian Gutierrez, Hunter Retrieval Services Registrar  |
| <b>1425</b>                    | <b>Questions</b>   |   |
| 1430                           | Shark attack!  | Dr Jean-Yves Kanyamibwa, Intensive Care Registrar/Advanced Trainee Emergency Medicine and Lynn Lelean, Media and Corporate Communications Manager, Mid North Coast LHD          |
| <b>1515</b>                    | <b>Questions</b>   |   |
| <b>1525</b>                    | <b>Afternoon Tea / Trade Display</b>   |   |
| <b>SESSION 4 – Free papers</b> |  |   |
| 1555                           | Emergency departments staffs opinions of mechanical cardiopulmonary resuscitation (CPR) versus manual CPR  | Daniel Van Vorst, ACNE, ED Liverpool Hospital   |
| 1605                           | MANSCARA: a makeover for your workforce  | Phil Way, District Clinical Network Manager and Kane Wyborn, Workforce Planning, HNE LHD  |
| 1625                           | Developing a simulation program to aid the introduction of a new clinical service such as a post-operative cardiothoracic care to an Intensive Care Unit (ICU) | Narrell O'Dea, CNS ICU & Simulation Coordinator JHH and Ursula Beckman, Intensivist, Calvary Mater Hospital   |
| <b>1645</b>                    | <b>Questions</b>   |   |
| <b>1700</b>                    | <b>Close</b>   |   |
| <b>1830-2300</b>               | <b>Sit down Dinner and dancing - Dress: Smart Casual</b>   | <i>Semillon rooms 1 and 2 (left of No.10 on Hotel map)</i>  |



# Program Friday 6th May 2016

| TIME                           | TOPIC   | SPEAKER   |
|--------------------------------|---|---|
| 0830                           | <b>Registration</b>   |   |
| <b>SESSION 1</b>               |   |   |
| 0850                           | <b>Welcome / Housekeeping</b>   | Nicole Coleman, CNC Donation Specialist Nurse   |
| 0900                           | ICE: the new crisis of stimulant abuse and addiction  | Dr Paul Preisz, Associate Professor in Emergency Medicine. Deputy Director and Staff Specialist in Emergency Medicine St Vincent's Hospital. Senior Staff Specialist in Emergency Sydney Hospital |
| 0925                           | <b>Questions</b>  |   |
| 0930                           | ICU Service Model Implementation-local experience   | Dr Andrew White, Director HDU, Grafton Hospital   |
| 0950                           | <b>Questions</b>  |   |
| 0955                           | Spinal fractures and surgical intervention  | Dr Mitchell Hansen, Neurosurgeon, John Hunter Hospital  |
| 1015                           | <b>Questions</b>  |   |
| 1020                           | Results of the Severe/Life-threatening Bronchiolitis Observational Study                                      | Dr Elizabeth Kepreotes, Clinical Nurse Consultant, John Hunter Children's Hospital  |
| 1035                           | <b>Questions</b>  |   |
| 1040                           | <i>Morning Tea / Trade Display</i>  |   |
| <b>SESSION 2 – Free papers</b> |   |   |
| 1110                           | Another retrieval perspective - Royal Australian Airforce Aeromedical Evacuation                              | Lynette Howell, RN ICU, John Hunter Hospital  |
| 1130                           | Surviving the improbable: a complex rehabilitation journey from ECMO to ARJO and beyond                       | Olivia McGuinness and Charlotte McLennan, Physiotherapists, Royal Prince Alfred Hospital  |
| 1150                           | Check the 8 & Take a Mate; A Leadership Approach to Quality in the ED   | Nicola Churms, CNE ED, Maitland Hospital  |
| 1210                           | Non-invasive ventilation for acute exacerbations of asthma: Does current practice reflect available evidence? | Elyce Green, CNS ICU, Wagga Wagga   |
| 1220                           | Experiences of fatigue following critical illness: a mixed methods study                                      | Zoe Colman, Physiotherapist, University of Newcastle School of Health Sciences  |
| 1230                           | <b>Questions</b>  |   |
| 1240                           | <i>Lunch / Trade Display</i>  |   |
| <b>SESSION 3</b>               |   |   |
| 1340                           | When trauma is close to home  | Julie Richards, CNE Royal Newcastle Centre; Kate King, CNC John Hunter Trauma Services and Mr Richards, Consumer  |
| 1410                           | <b>Questions</b>  |   |
| 1415                           | Medecins Sans Frontieres: Surgery in an austere environment   | Dr Martin Jarmine, Trauma Fellow, John Hunter Hospital Trauma Services  |
| 1435                           | <b>Questions</b>  |   |
| 1440                           | Moral distress in ICU   | Dr Ray Asimus, Staff Specialist ICU John Hunter Hospital & Director Lingard Private Hospital  |
| 1500                           | <b>Questions</b>  |   |
| 1505                           | Vascular air embolism   | Kaye Rolls, Clinical Project Officer, Intensive Care Coordination and Monitoring Unit, Agency for Clinical Innovation   |
| 1515                           | <b>Questions</b>  |   |
| 1520                           | The role of interventional radiology in trauma  | Kery Thomas, Senior Radiographer, John Hunter Radiology (Angiography)   |
| 1540                           | <b>Questions</b>  |   |
| 1545                           | <b>Presenter awards</b>   |   |
| 1555                           | <b>Delegate prizes</b>  |   |
| 1600                           | <b>Conference Close</b>   |   |

# Registration Form

## Critical Care Conference in the Vineyards 5th & 6th May 2016

**Crowne Plaza Hunter Valley**

**Closing date for registration: Monday 18th April 2016.**

*Please complete one form for each delegate and mail, fax or scan with payment to:*

**Centralised Revenue Unit Waratah**

**Locked Bag 1, Hunter Region Mail Centre, NSW 2310**

**Fax: 02 4985 3317 or Email: HNELHD-centralisedbilling@hnehealth.nsw.gov.au or Phone: 02 4985 3324**

*NB: Please write legibly so the receipts are sent to the right address*

### personal details:

Title (Prof/Dr/Mr/Mrs/Miss/Ms) Surname \_\_\_\_\_

Given names \_\_\_\_\_

Hospital \_\_\_\_\_ Speciality \_\_\_\_\_

Postal Address (H) \_\_\_\_\_

Suburb/Town \_\_\_\_\_ State \_\_\_\_\_ Postcode \_\_\_\_\_

Telephone (M) \_\_\_\_\_ (H) \_\_\_\_\_

Fax \_\_\_\_\_ Email address \_\_\_\_\_

Special Dietary requirements \_\_\_\_\_

### delegate payment (including gst):

*Please choose carefully, as catering is finalised prior to the event based on registration preferences*

PLEASE  
TICK

#### REGISTRATION FOR DELEGATES:

|   | Cost  |
|---|-------|
| <input type="checkbox"/> <b>Early bird</b> (strictly before Friday 4th March 2016) Registration <i>(including dinner)</i> ..... | \$395 |
| <input type="checkbox"/> <b>Full Registration</b> <i>(including dinner)</i> .....   | \$410 |
| <input type="checkbox"/> <b>2 Day Registration only</b> <i>(dinner NOT included)</i> .....                                      | \$280 |
| <input type="checkbox"/> <b>Thursday 5th May 2016</b> 1 Day Registration only .....   | \$205 |
| <i>(Tick below if required dinner ticket)*</i>  |       |
| <input type="checkbox"/> <b>Friday 6th May 2016</b> 1 Day Registration only .....   | \$205 |
| <i>(Tick below if required dinner ticket)*</i>  |       |
| <input type="checkbox"/> Extra guest or 1 day registration dinner ticket.....   | \$115 |

**NB Dinner includes 3 course meal, drinks and dancing at the Conference Venue**

#### PAYMENT TOTAL incl. GST

Registration Fee \$ \_\_\_\_\_ + Guest / extra dinner ticket (if applicable) \$ \_\_\_\_\_

**= Total Payment \$ \_\_\_\_\_**

### payment options:

**EFT funds transfer** (If you check this box, you must use funds transfer from your own online banking account)  
Bank: **Westpac** Location: **North Sydney** Account Name: **Hunter New England Local Health District**  
BSB: **032-099** Account Number: **520642**

Reference: 'CCCV' followed by your surname and first initial (e.g. CCCVsmithr)  
Email notification of payment to HNELHD-centralisedbilling@hnehealth.nsw.gov.au

I enclose:

**Cheque** Amount: \$ \_\_\_\_\_  
(Please make cheque/money order payable to: Hunter New England Local Health District)

**Credit Card** Amount: \$ \_\_\_\_\_  
Please debit my:  Visa  Mastercard  Bankcard  AMEX

Card Number: \_\_\_\_\_ Expiry Date: \_\_\_\_\_ / \_\_\_\_\_

Cardholder's Name: \_\_\_\_\_

Cardholder's Signature: \_\_\_\_\_

**NB: Payment at time of registration is required to attend this conference. If a delegate is sponsored by their workplace, they must make an upfront payment and be reimbursed by their employer.**

### A Tax Invoice/Receipt will be issued on receipt of payment

Address for payment if different to above

Fax \_\_\_\_\_ Email \_\_\_\_\_

OFFICE USE ONLY: CREDIT 604796-10000-2781-0000

Contact details for payment: Centralised Revenue Unit Waratah: 02 4985 3324 or Louise Abel (conference secretariat): 02 4921 4259

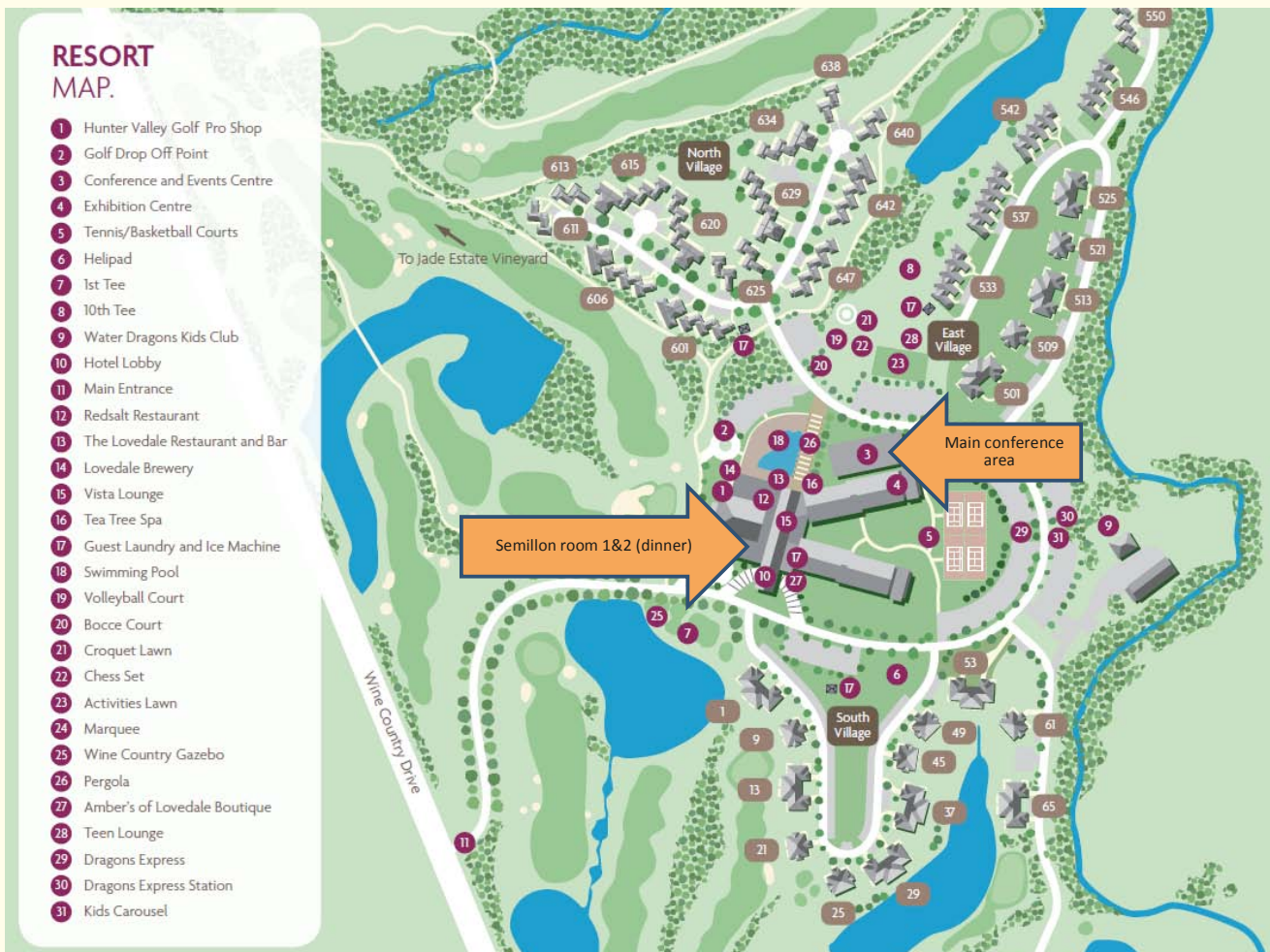

## RESORT MAP.

- 1 Hunter Valley Golf Pro Shop
- 2 Golf Drop Off Point
- 3 Conference and Events Centre
- 4 Exhibition Centre
- 5 Tennis/Basketball Courts
- 6 Helipad
- 7 1st Tee
- 8 10th Tee
- 9 Water Dragons Kids Club
- 10 Hotel Lobby
- 11 Main Entrance
- 12 Redsalt Restaurant
- 13 The Lovedale Restaurant and Bar
- 14 Lovedale Brewery
- 15 Vista Lounge
- 16 Tea Tree Spa
- 17 Guest Laundry and Ice Machine
- 18 Swimming Pool
- 19 Volleyball Court
- 20 Bocce Court
- 21 Croquet Lawn
- 22 Chess Set
- 23 Activities Lawn
- 24 Marquee
- 25 Wine Country Gazebo
- 26 Pergola
- 27 Amber's of Lovedale Boutique
- 28 Teen Lounge
- 29 Dragons Express
- 30 Dragons Express Station
- 31 Kids Carousel

## ABOUT THE HUNTER VALLEY

### How to Get There

Crowne Plaza Hunter Valley, 430 Wine Country Drive, Lovedale, Hunter Valley NSW 2321

Map available via the venue accommodation site link.

### Aircraft

You can fly direct to Newcastle or Sydney airport from most capital cities, on the following services: - Virgin Blue - Qantas - Jetstar  
Newcastle airport is located in Williamtown and is approximately an 50-60 minutes drive to the Hunter Valley. Sydney airport is located in Mascot and is approximately a 2hr 30min drive to the Hunter Valley.

### Accommodation

It is the delegate's responsibility to organise their own accommodation. The venue has set up an accommodation link to book rooms if you so choose as per below:

<https://resweb.passkey.com/go/criticalcareconference2016>

(NB if the link doesn't open page you will need to copy and paste the link into your browser).

For delegates who do not wish to book via the link, please call the venues in house Reservations team on 4991 0970 between the hours of 9.00am - 5.00pm Monday to Friday and quote: "booking is for the Critical Care Conference in the Vineyards". Otherwise please use your own preferred accommodation booking site.

## CONDITIONS:

### Cancellations

Fees may be reimbursed if possible if an email is sent via the conference email address up to 3 weeks prior to the conference date (18th April 2016). We regret that no refunds will be made less than 21 days prior to the conference regardless of the reason for cancellation.

### Program

The conference committee reserves the right to change the program at anytime without notice.

### Receipts and Payments

A tax invoice will be issued on receipt of payment via email or fax as identified on your registration form.

No conference registrations will be accepted without prior payment being received.

Venue capacity is limited. Closing date for registration **and** payment is Monday 18th April 2016, unless fully booked prior to this date.

### Insurance

Delegate's registration fees do not include insurance of any kind. The organisers suggest you may wish to take out an insurance policy of your own choice. Please contact your preferred travel insurance provider to arrange prior to attendance.

### Delegates Entry Pass

Delegates will receive a name badge on arrival at the conference. This badge will be your official pass and must be worn to obtain entry to all sessions.

